

# C720 (sliding gate motor)

## MANUAL OPERATION



**WARNING: BEFORE CARRYING OUT THE RELEASE AND SHUT-DOWN OPERATIONS, MAKE SURE THAT YOU HAVE CUT POWER TO THE OPERATOR.**

### 8 OPERATOR RELEASE/LOCK



*During the release/lock manoeuvre, take care to prevent an involuntary pulse from operating the gate.*

Proceed as follows to release the gearmotor:

1. Turn the release clockwise as shown in Fig. 21 re. ①. The release lever will move slightly away from the operator body (Fig. 21 re. ②).
2. Fully lower the release lever to the mechanical stop (Fig. 21 re. ③).
3. Carry out the opening or closing manoeuvre manually.

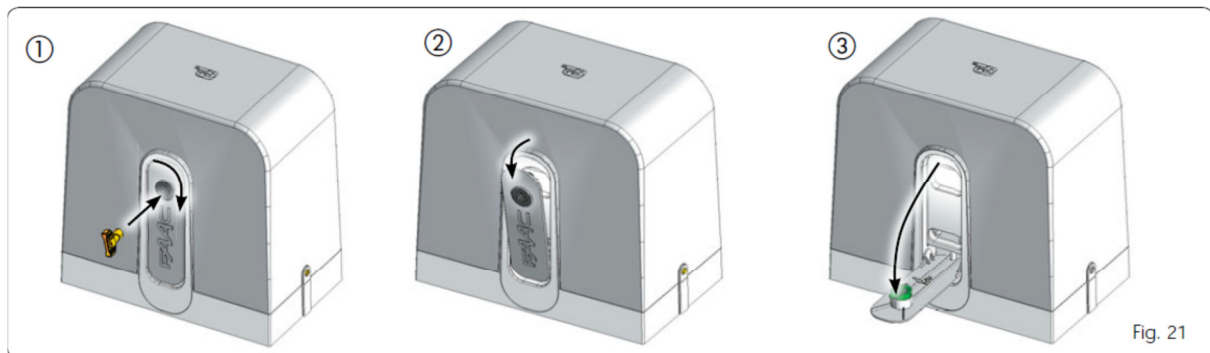

Fig. 21